

N24 200

SISTEMA DE CORRER PERIMETRAL
COM RUTURA DE PONTE TÉRMICA

Perimetralslidingsystemwiththermalbreak



ARQUITETURA: JOSÉ ADRIÃO ARQUITETOS FOTOGRAFIA: NUNO ALMENDRA

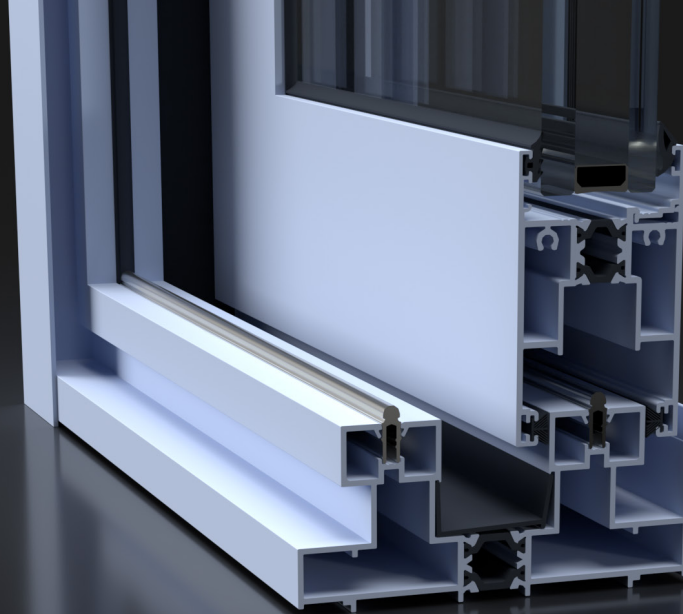

Sistema de correr perimetral com rutura de ponte térmica, linhas retas, aros fixos de 118mm de profundidade, com opção em tri-rail e quadri-rail, e aros móveis de 81,7mm de vista. Sistema termicamente melhorado pela inclusão de poliamidas, indo de encontro às necessidades atuais de qualidade com performances elevadas e de fácil manuseamento.

Com múltiplas soluções construtivas, possibilita a execução de caixilhos de grandes dimensões e vãos bicolores. Permite a execução de vãos de correr tradicionais e folhas de correr eleváveis, mediante um acessório próprio que facilita a manobra e deslizamento da folha.

Com o perfil N24 265, este sistema permite a fabricação de folhas com bite, aumentando-se a facilidade de fabricação dos caixilhos. O perfil N24 265 permite, também, a fabricação de folhas de correr tradicionais e folhas de correr eleváveis no mesmo caixilho.

Aro fixo: 118mm (opção bi-rail)
Vidro: até 36mm

Perimetral sliding system with thermal break assembly, straight lines, fixed frames of 118mm depth, with 3-rail and 4-rail options, and sashes with a view of 81,7mm. Thermally improved system through the inclusion of polyamides, meeting the current quality requirements, with high performances and easy handling. With multiple constructive solutions, it enables the execution of large dimensions sashes and bicolour finishing. It allows traditional sliding openings and lift-slide sashes through a specific accessory that makes it easier to manoeuvre and slide. With N24 265 profile, this system allows the manufacturing of sashes with glazing beads, increasing the frames' ease of manufacturing. The N24 265 profile allows, also, the manufacturing of traditional sliding openings and lift-slide sashes in the same frame.

Fixed frame: 118 mm (bi-rail option)
Glazing: up to 36mm

N24 200 COM BITE

N24200MTHGLAZINGBEAD

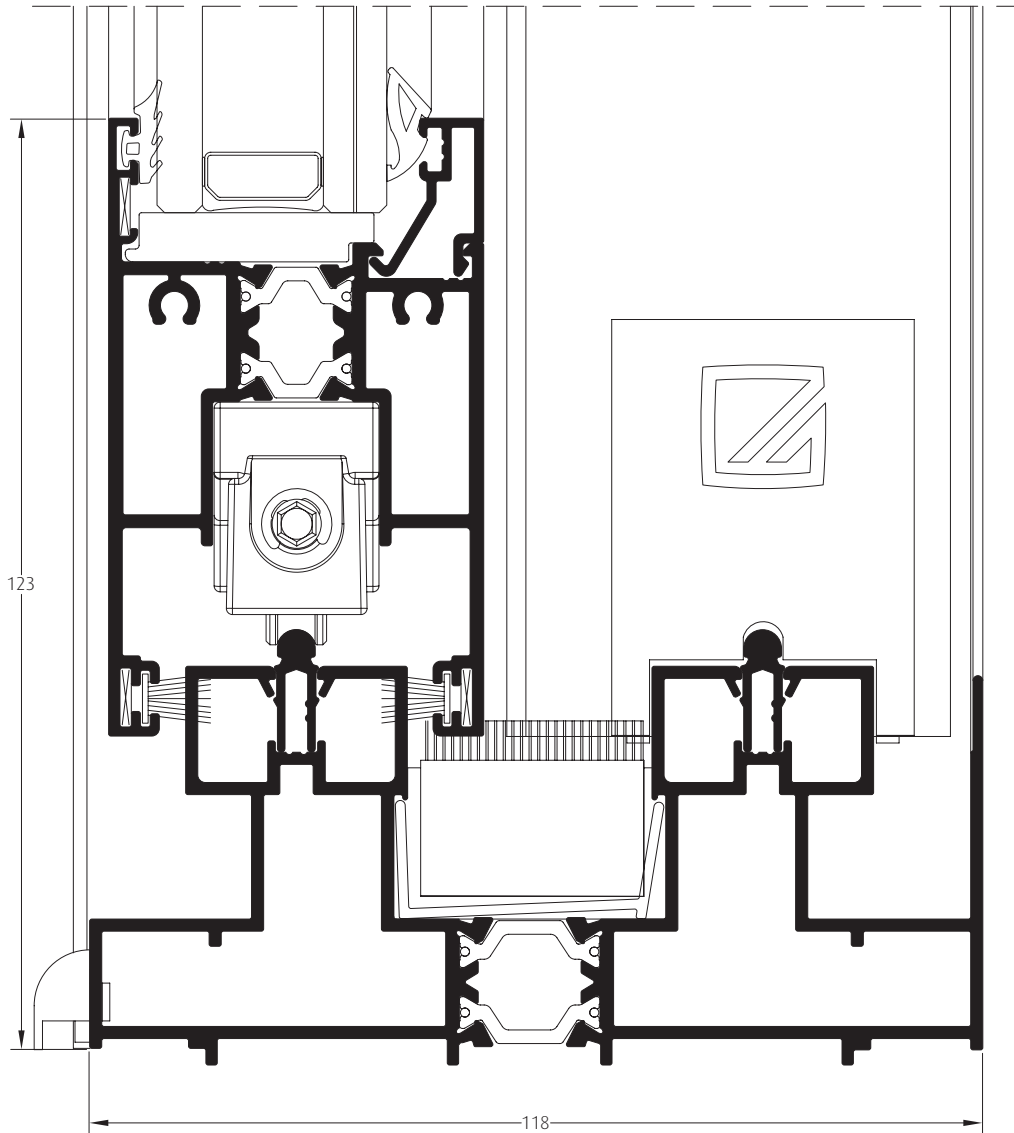

[escala scale 1:1]

**FACILIDADE DE FABRICAÇÃO COM MAIOR
GAMA DE SOLUÇÕES NO MESMO CAIXILHO**

Ease of fabrication with a wide range of solutions in the same frame

AROS FIXOS PERIMETRAIS | PERIMETRAL OUTER FRAMES

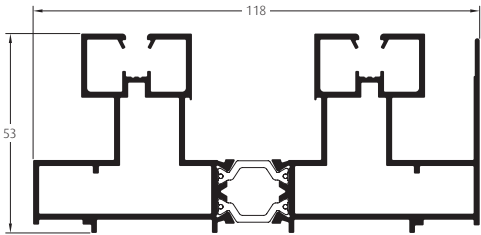

N24 203

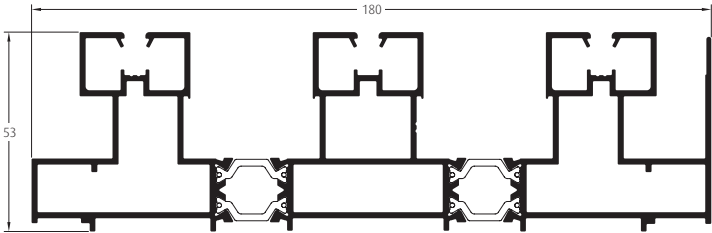

N24 204

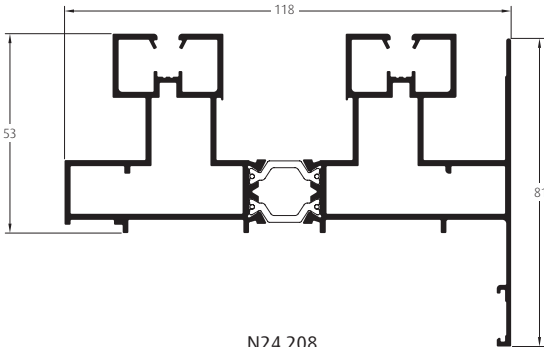

N24 208

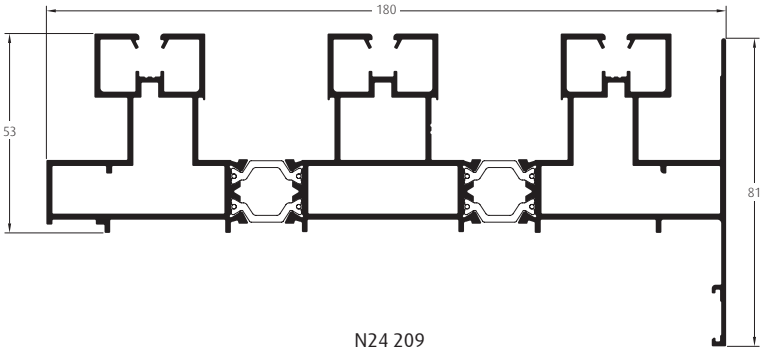

N24 209

AROS FIXOS PERIMETRAIS | PERIMETRAL OUTER FRAMES

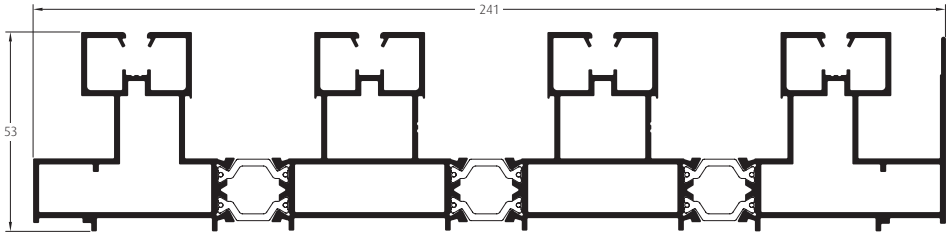

N24 205

AROS MÓVEIS PERIMETRAIS | PERIMETRAL VENT PROFILES

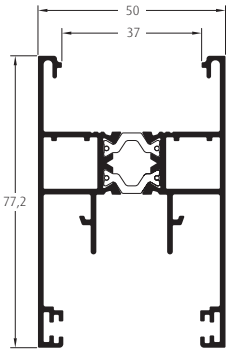

N24 261

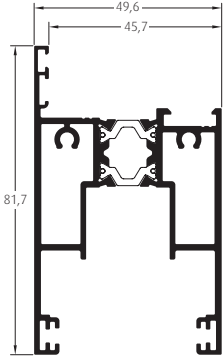

N24 265

AROS MÓVEIS CENTAIS | CENTRAL VENT PROFILES

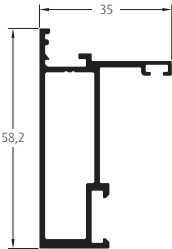

N24 266

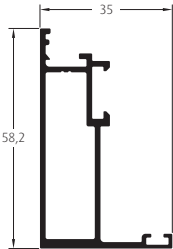

N24 267

PERFIL DE REFORÇO | REINFORCEMENT PROFILE

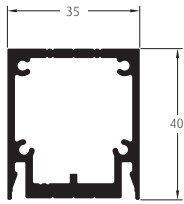

N24 961

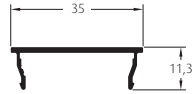

N24 963

PERFIS COMPLEMENTARES | ADDITIONAL PROFILES

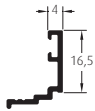

N24 253

(bite para 24 265/glazing bead for 24 265)

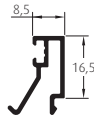

N24 254

(bite para 24 265/glazing bead for 24 265)

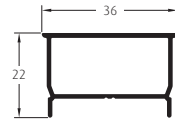

N24 292

(capa de janela invertida/cover profile for inverted window)

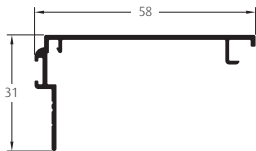

N24 293

(capa central/central cover profile)

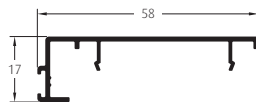

N24 294

(capa central rede mosquiteira para perfil n31 526/
mosquito net central cover profile for n31 526)



N24 295

(guia de janela invertida/
inverted window guide)



N24 297

(guia de janela invertida/
inverted window guide)

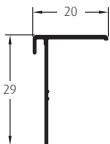

N21 093

(para apanelado/for boarding)



N30 222

(capa exterior/outside cover profile)



N26 094

REDE MOSQUITEIRA | MOSQUITO NET

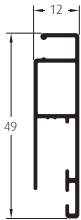

N31 524

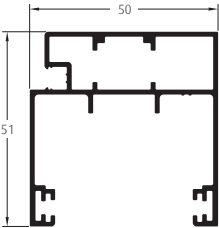

N31 526

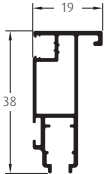

N31 527

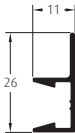

N31 528

(com utilização da mola DIV.006/with DIV.006 window)

MONTAGENS assemblies

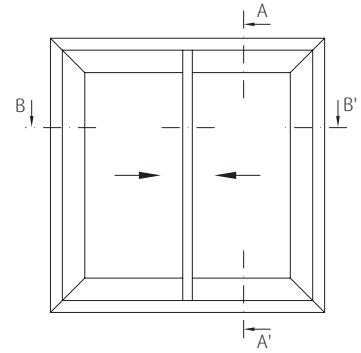
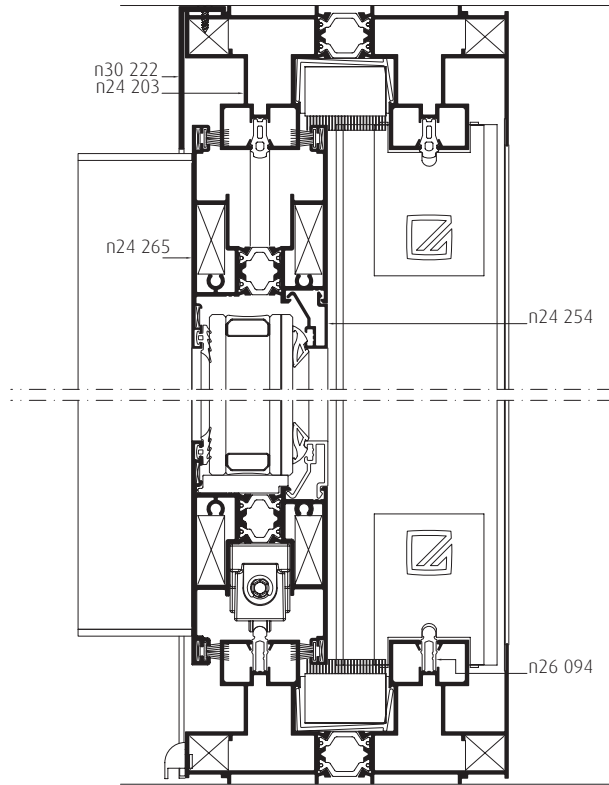

Corte A-A'
Section A-A'

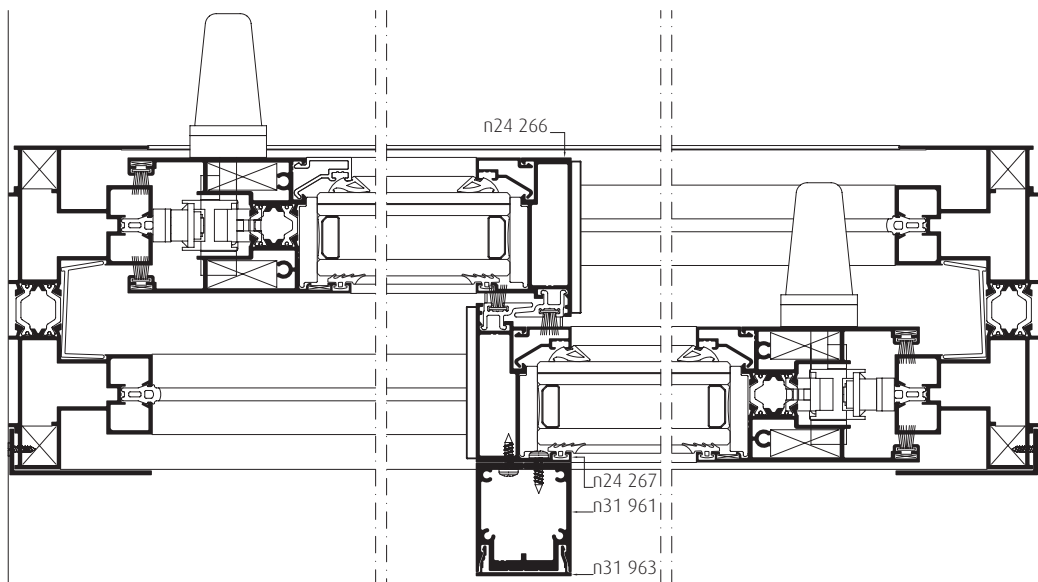

Corte B-B'
Section B-B'

MONTAGENS assemblies

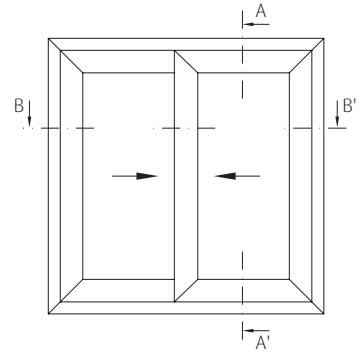
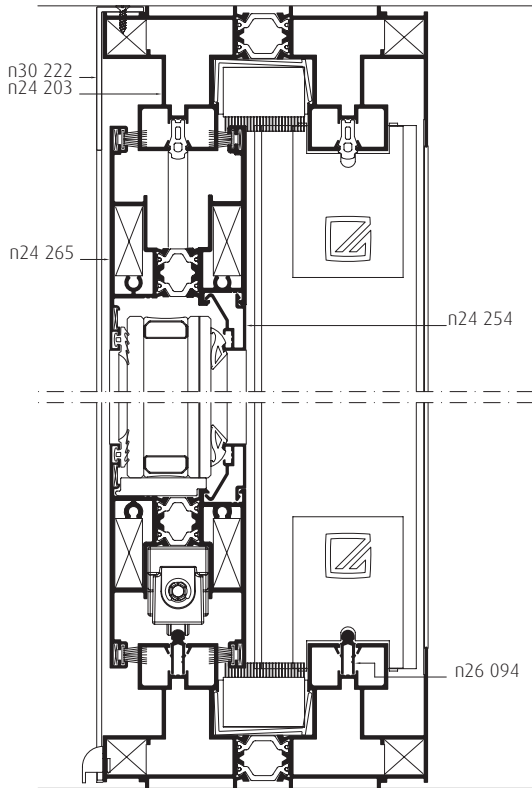

Corte A-A'
Section A-A'

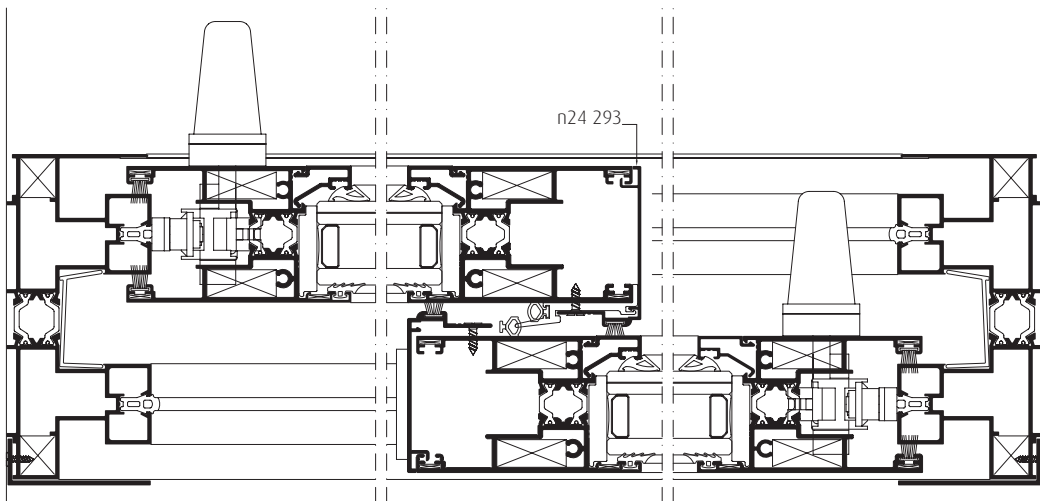

Corte B-B'
Section B-B'

TIPOLOGIAS

TYPLOGIES

TIPOLOGIAS DISPONÍVEIS

AVAILABLE TYPOLOGIES

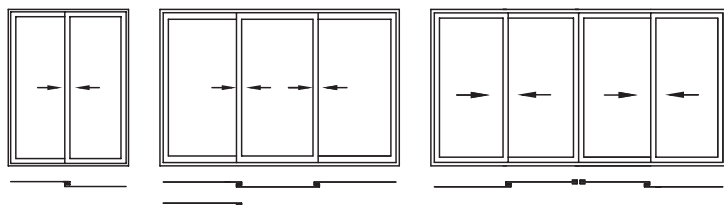

3-RAIL

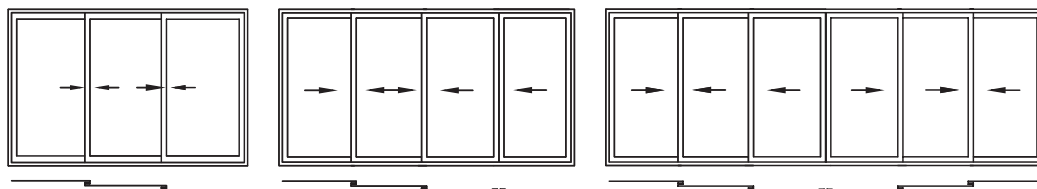

ELEVÁVEL/LIFT-SLIDE

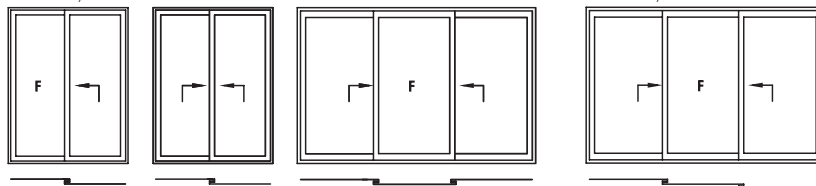

ELEVÁVEL/LIFT-SLIDE 3-RAIL

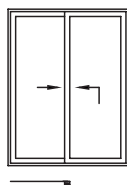

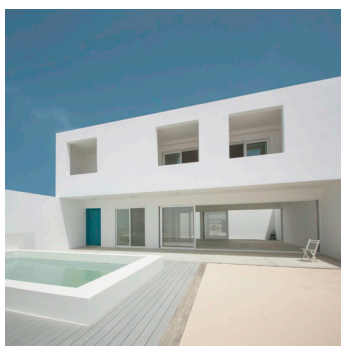
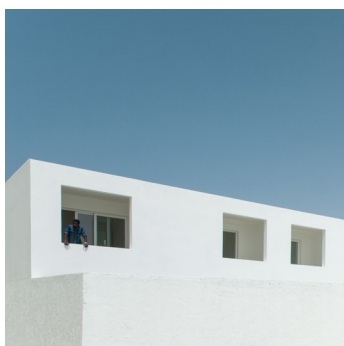
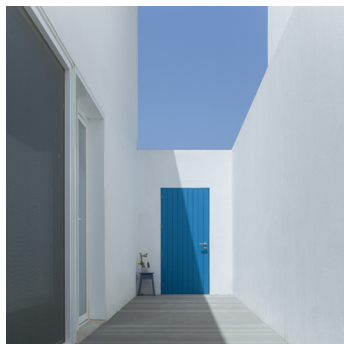

OBRA: PRAIA DO ESTORIL, CABO-VERDE
ARQUITETURA: JOSÉ ADRIÃO ARQUITETOS
FOTOGRAFIA: NUNO ALMENDRA

A Navarra - Extrusão de Alumínio, S.A. reserva-se no direito de proceder sem aviso prévio a alterações em todo ou parte do conteúdo apresentado, invalidando todas as versões anteriores.

Navarra - Extrusão de Alumínio, S.A. reserves the right to make unannounced changes to all or part of the content presented, invalidating all previous versions.

As imagens contidas nesta peça são meramente exemplificativas.

The images contained in this brochure are merely illustrative.

EDIFÍCIO SEDE | HEAD OFFICE
CENTRO DE INVESTIGAÇÃO | RESEARCH CENTRE
SHOWROOM BRAGA | BRAGA SHOWROOM
Navarra - Extrusão de Alumínio, S.A.
Avenida Doutor Domingos Soares, nº 18
4710-670 Braga

COORDENADAS GPS | GPS COORDINATES
41° 36' 10.582" N
8° 22' 52.554" W

ENDEREÇO POSTAL | POSTCODE
Navarra - Extrusão de Alumínio, S.A.
Apartado 2476
4701-971 BRAGA

t. + 351 253 603 520
f. + 351 253 677 005
geral@navarraaluminio.com
comercial@navarraaluminio.com
export@navarraaluminium.com

SHOWROOM LISBOA | LISBON SHOWROOM
Parque das Nações
Alameda dos Oceanos
Edifício Mar do Oriente, n.º63 fração 0.1
1900-137 Lisboa

t. + 351 218 965 032
showroomlisboa@navarraaluminio.com

COORDENADAS GPS | GPS LOCATION
38° 46' 17.4" N
9° 05' 44.4" W

www.navarraaluminio.com
www.navarrabim.com

Descubra a nossa APP navarra® AR
Discover our Navarra® AR APP



 **navarra®**
a marca do alumínio
the aluminium brand